

CORTE A-A
ESC: 1/75

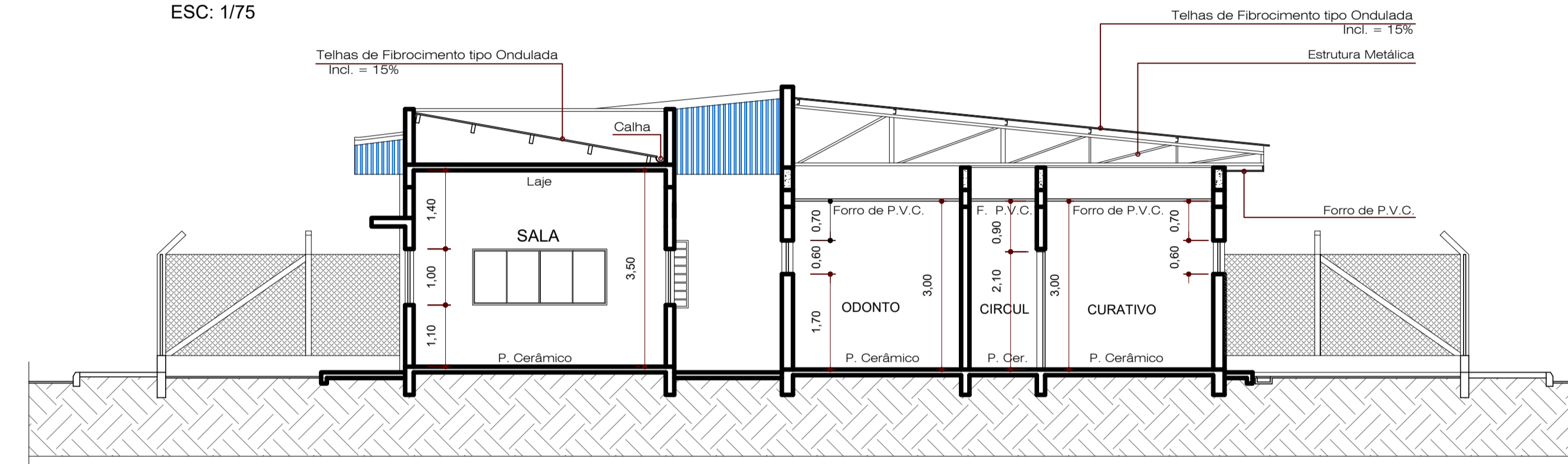

CORTE B-B
ESC: 1/75

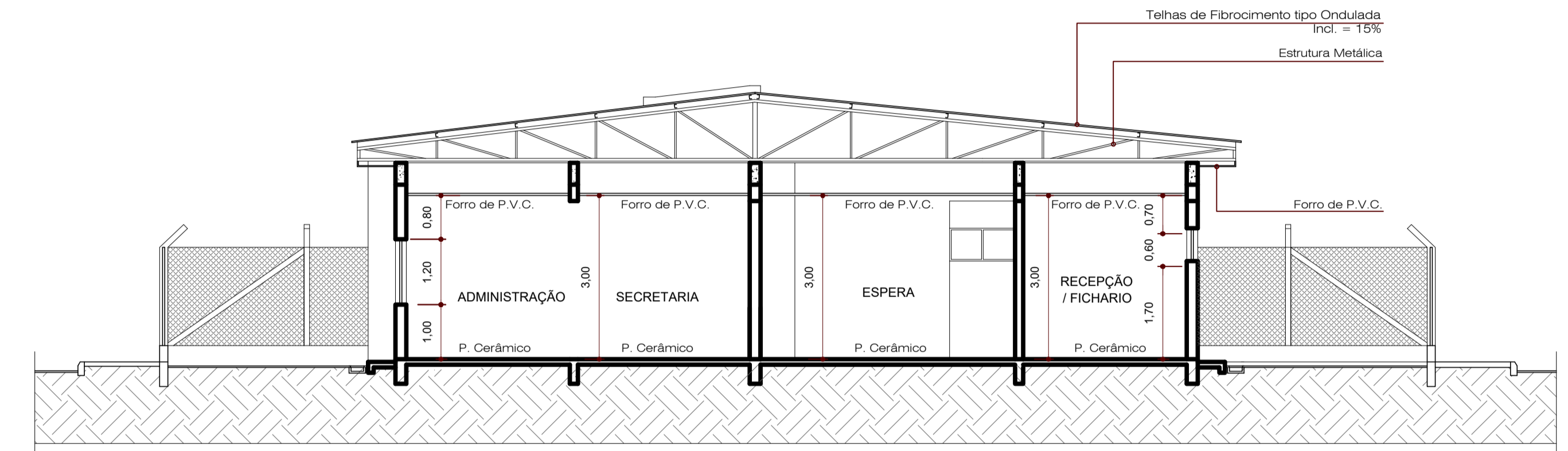

CORTE C-C
ESC: 1/75

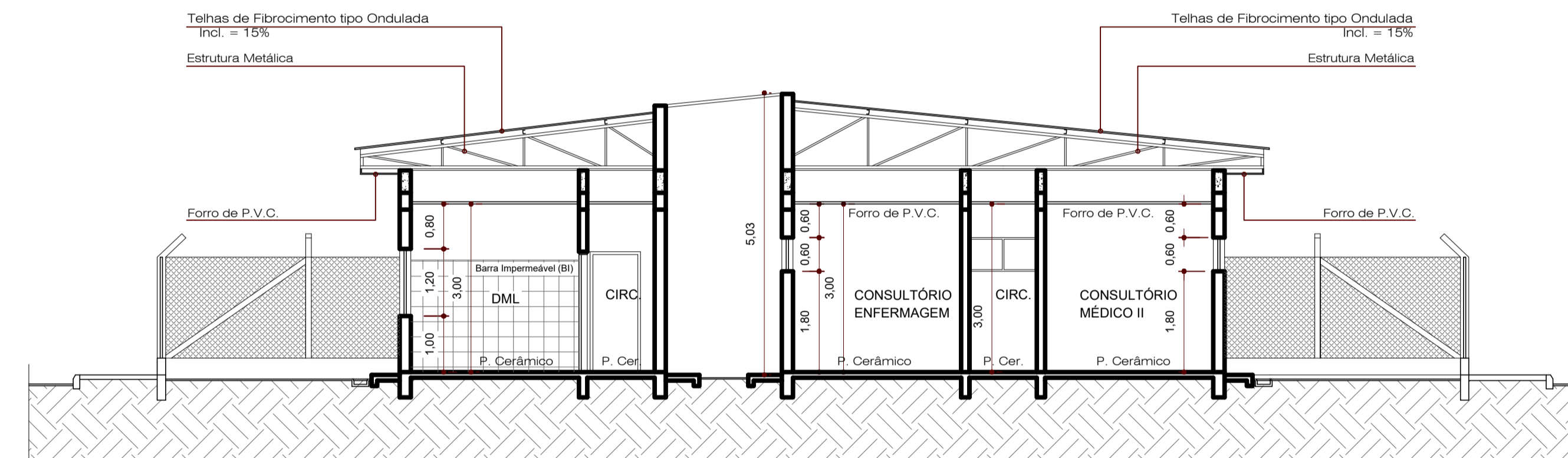

CORTE D-D
ESC: 1/75

LEGENDA DAS PAREDES

- ==== PAREDES EXISTENTES
- ==== PAREDES A CONSTRUIR

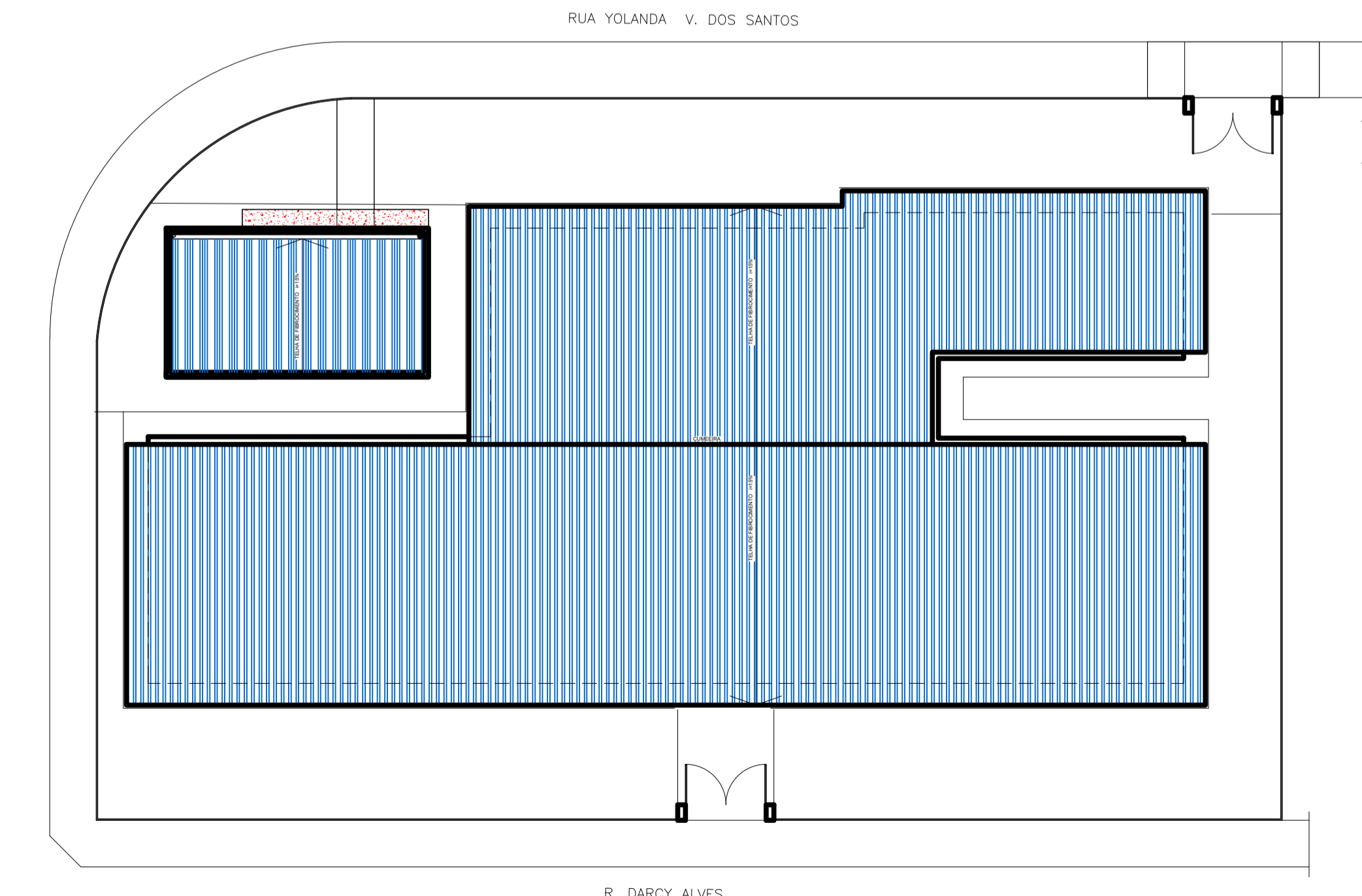

COBERTURA
ESC: 1/150

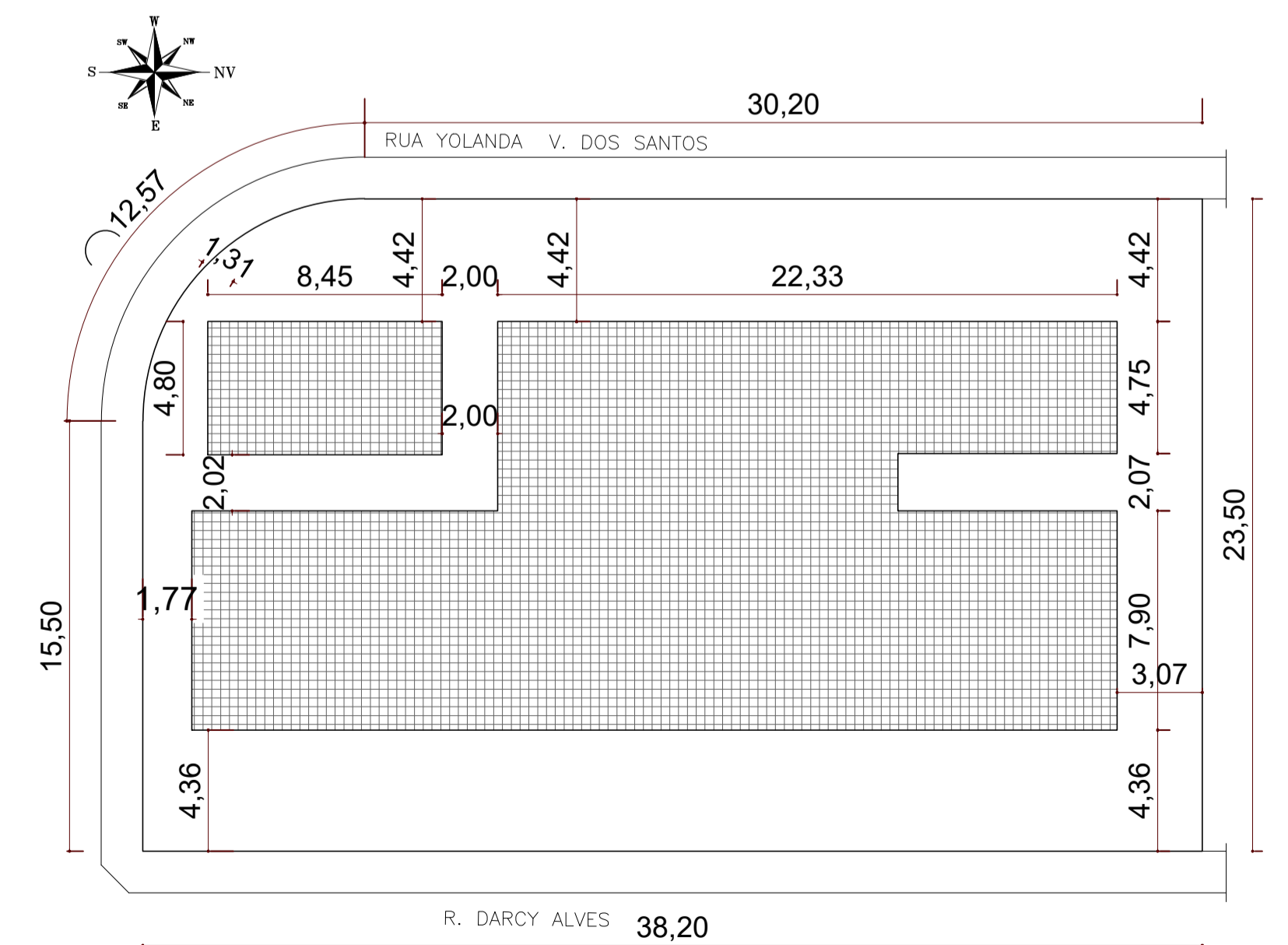

IMPLANTAÇÃO
ESC: 1/200

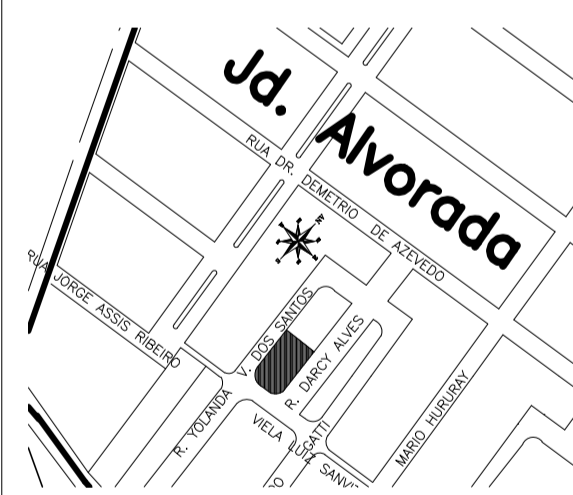
PROJETO ARQUITETÔNICO		PRAXIA
 PREFEITURA DE ITARARÉ SECRETARIA DE DESENVOLVIMENTO MUNICIPAL		DES / CAD DERIMAR
REFORMA GERAL POSTO SAÚDE JARDIM ALVORADA		DATA FEV / 2020
ENDEREÇO Rua Darcy Alves n° 35 - Jardim Alvorada - Itararé - SP		
SITUAÇÃO 		PREFEITO MUNICIPAL HELTON SCHEID DO VALLE Gestor: 2017/2020
QUADRO DE ÁREAS TERRENO..... 883,96 m² CONSTRUÇÃO..... 381,04 m² LIVRE..... 502,92 m²		RESP. TÉCNICO JOÃO BATISTA ALVES DOS SANTOS Engenheiro CREA 5061205/02 D
ESPAÇO RESERVADO PARA APROVAÇÃO		